

- KEY
- Proposed carriageway surfacing
 - Proposed raised table
 - Proposed shared use area
 - Proposed crossing tactile paving
 - Proposed verge
 - Proposed bollard
 - Proposed belisha beacon

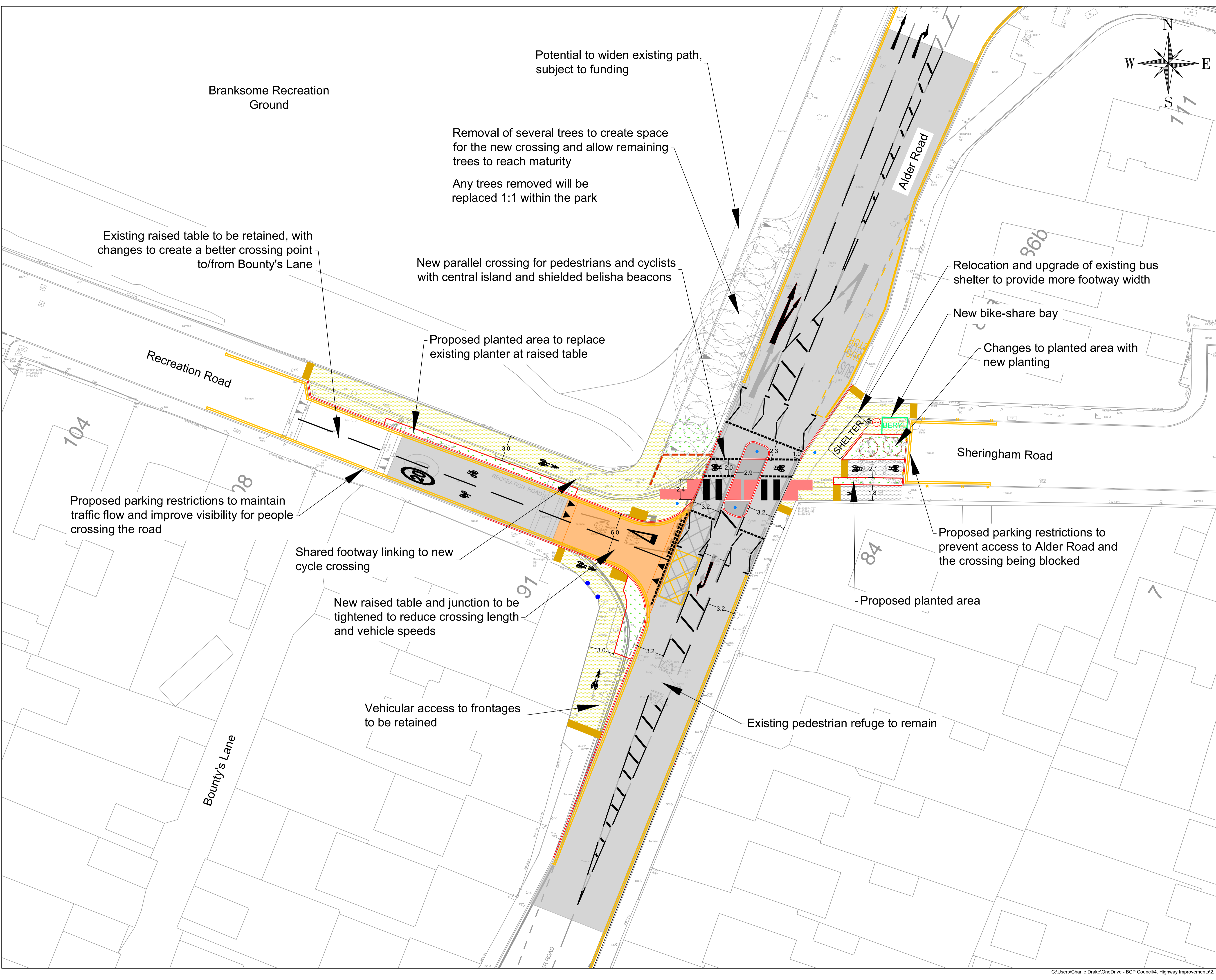
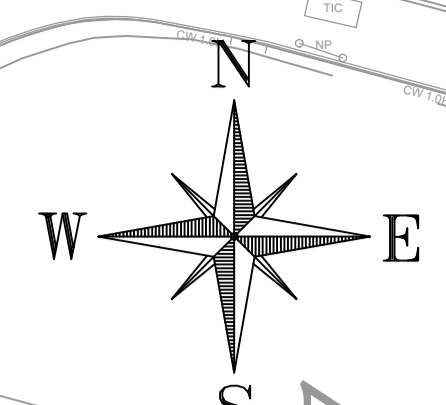

Branksome Recreation Ground

Potential to widen existing path, subject to funding

Removal of several trees to create space for the new crossing and allow remaining trees to reach maturity
 Any trees removed will be replaced 1:1 within the park

Existing raised table to be retained, with changes to create a better crossing point to/from Bounty's Lane

New parallel crossing for pedestrians and cyclists with central island and shielded belisha beacons

Relocation and upgrade of existing bus shelter to provide more footway width

New bike-share bay

Changes to planted area with new planting

Proposed planted area to replace existing planter at raised table

Recreation Road

Alder Road

Sheringham Road

SHELTER
 BERYL

Proposed parking restrictions to maintain traffic flow and improve visibility for people crossing the road

Proposed parking restrictions to prevent access to Alder Road and the crossing being blocked

Shared footway linking to new cycle crossing

New raised table and junction to be tightened to reduce crossing length and vehicle speeds

Proposed planted area

Vehicular access to frontages to be retained

Existing pedestrian refuge to remain

Bounty's Lane

P01	17/12/25	First issue
Rev.	Date	Description

Engineering



M.Raudsepp
 Service Director of
 Customer and Property

Project Title:
Active Travel Fund Improvements

Drawing Title:
Consultation Plan Potential Changes for Alder Road Crossing

Drawn: CD	Checked: SH	Approved: SH
Date: 17/12/2025	Scales: 1:200 @ A1	
Drawing Number: MU4515_H_P_0021_P_0110	Rev: P01	